

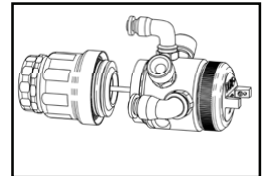

# AUTOMATIC

## QUICK REFERENCE & MAINTENANCE GUIDE

The Dux Automatic Spray Gun is a tool that delivers superior finishing results and cost savings. Optimal performance and results require proper handling and maintenance processes.

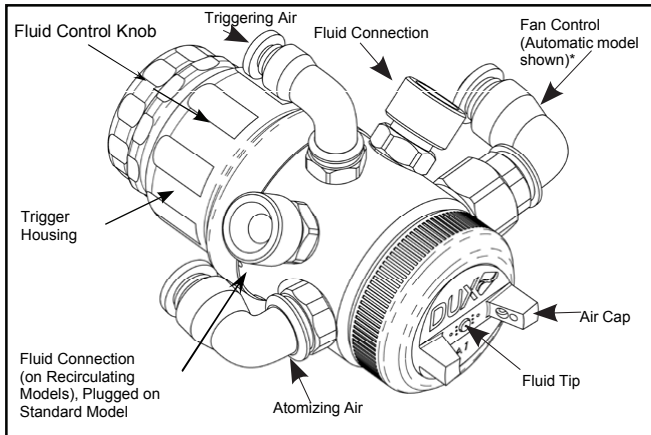

Unscrew Trigger Housing

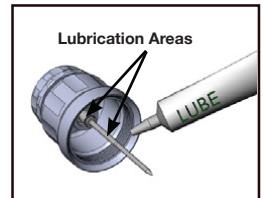

Lubricate thick part of needle and needle O-ring liberally

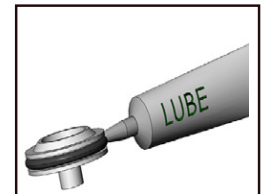

Lubricate trigger piston O-ring liberally

**CAUTION:** DE-PRESSURIZE GUN PRIOR TO PERFORMING ANY FLUID PACKING ADJUSTMENTS, MAINTENANCE, OR CLEANING  
**Note:** On Automatic Fan Control Models, Dux recommends the Fan Control Air always be at least 5 psi Lower than Atomizing Air

**Important:**  
Some coating leakage out of the fluid tip may indicate an adjustment of the packing is needed. This is not an indication of the spray gun failing. This may occur after setup, after a period of spraying, or when material is changed

**Step 2:** Insert a Dux Packing Driver or a thin, flat-blade screw-driver into rear of gun

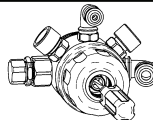

**Step 1:** Unscrew the Fluid Control Knob (complete with Locking Ring & Needle) and separate from the gun

**Step 3:** Turn Clock-Wise to tighten pack-ing, counter-clockwise to loosen packing

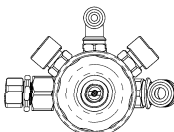



For Product Manuals  
And  
Additional Resources Please Visit  
[DuxTechnologiesInc.com/product-manuals](http://DuxTechnologiesInc.com/product-manuals)

